

wiper A62-C

seal spec

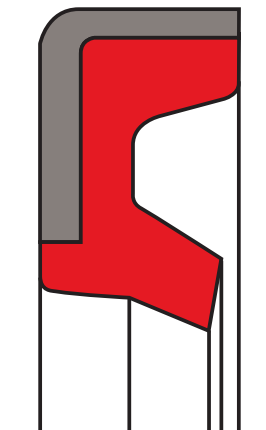

description

the profile A62-C wiper ring serves the purpose of preventing the penetration of dust, dirt, sand, and metal swarf at the spherical bearings of a hydraulic cylinder rod end. this reduces the danger of „scuffing“ on the swivel bolt as a result of contamination from external sources. the excellent wiping effect is achieved by the special design of the wiper lip. furthermore, the wiper lip opens up during lubrication allowing excess lubricant to escape.

the proven PU stands for high abrasion resistance, minor permanent deformation, and robustness vis-a-vis external mechanical impact. by means of a press fit of the metal scan vis-a-vis the external diameter of the seal housing, the wiper is securely held in place in the axially open installation housing. thanks to the flush end fit of the wiper lip with the swivel riveting jig the lip enjoys a high degree of protection against damage from external causes.

application



not bolded symbols; please consult our technical for application limitations

category of profile

molded/standard/trade product or machined with minor design change.

single acting

area of application: hydraulics

hydraulic cylinders and valves.

operating parameters & material

material		temperature	running surface speed
wiping part	housing		
s-mart PU (93 shore A)	metal (unalloyed steel DIN 1624)	-35 °C ... +100 °C	2 m/s

the stated operation conditions represent general indications. it is recommended not to use all maximum values simultaneously. surface speed limits apply only to the presence of adequate lubrication film.

surface quality

surface roughness	Rtmax (µm)	Ra (µm)
sliding surface	according to seal data	
bottom of groove	≤6,3	≤1,6
groove face	≤15	≤3

tolerance recommendation

seal housing tolerances	
ØD	H8

**fitting & installation**

the profile A62-C wiper rings are manufactured with a slightly oversized outer diameter D, thus ensuring a secure press fit in the groove DH8 after installation. any contact of the wiper lip with piston rod eyes or other connecting parts should be avoided.

the wiper is easily built in to split housing, provided the lead-in chamfer is in accordance with the table below:

H [mm]	chamfer [mm] with angle 20°
≤ 4,5	0,6
5	0,6
6	0,8
7	0,8
8	1
9	1
10	1,4
12	1,8
14	2
16	2,4

seal & housing recommendations

please note that we are able to produce those profiles to your specific need or any non standard housing. for detail measurements, please see seal-mart catalog...

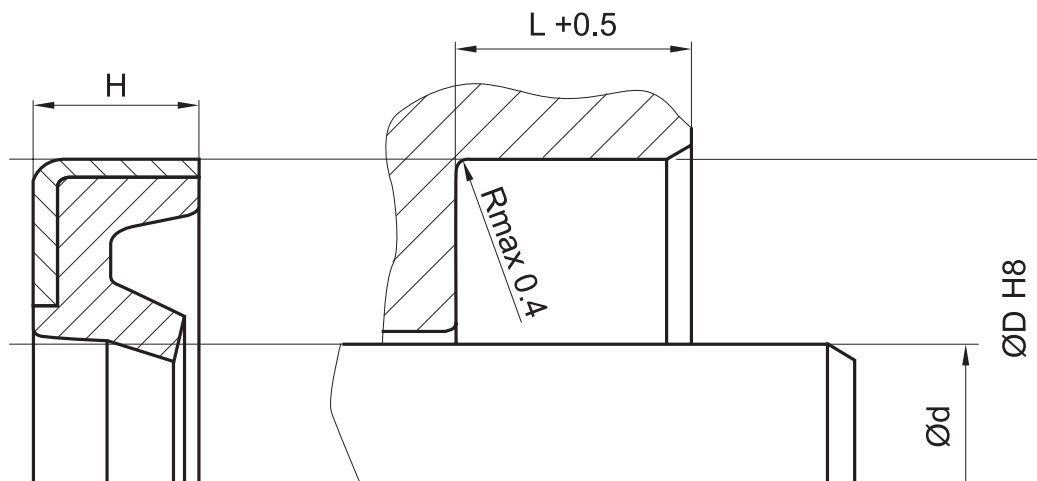

don't hesitate to contact our technical department for further information or for special requirements (temperature, speed etc.), so that suitable materials and/or designs can be recommended.